

NOTES:

1. MAX PRESSURE: 100PSI
2. DIMENSIONS: INCHES
3. REFER TO PRODUCTS:
31M900 (MALE)
 50130-1 (.063)
 50130-11 (.040)
 50131-2 BLANK CAP
31F900 (FEMALE)
 50130-2 (.063)
 50130-10 (.040)
 50130-9 BLANK CAP
31FB900 (FEMALE)
 50130-5 (.063)
 50130-7 (.063)
31FSB900 (FEMALE)
 50130-7 (.063)
4. WRENCH PART #1420-1A

5.  GASKET MATERIAL:
 50139-2 (SILICONE)
 *SUPPLIED WITH MALE CONNECTOR

REVISIONS			
REV	DESCRIPTION	DATE	APPROVED
-	PRODUCTION RELEASE	6-3-14	AE

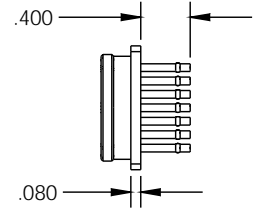
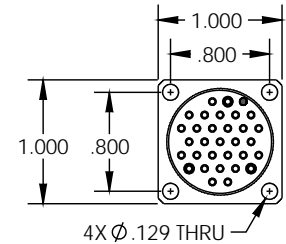
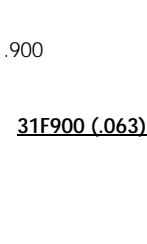
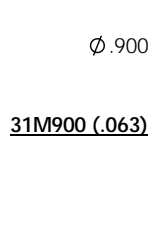
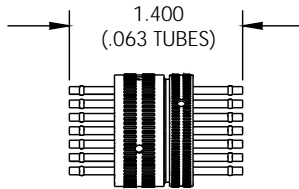

31FB900

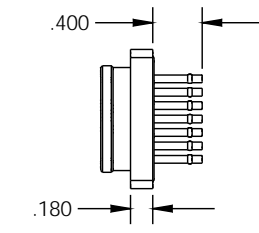
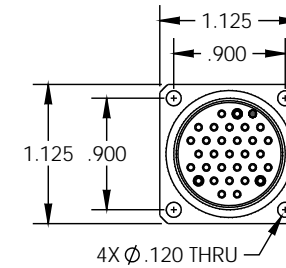
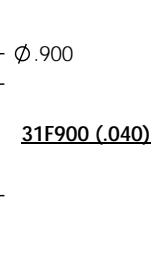
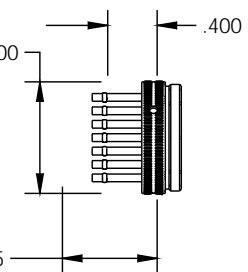
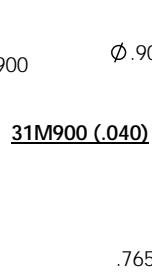
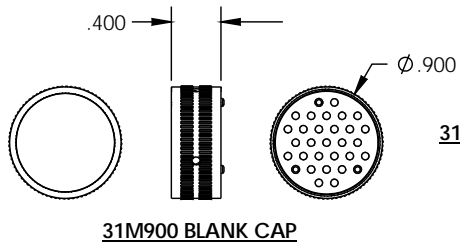

31FSB900

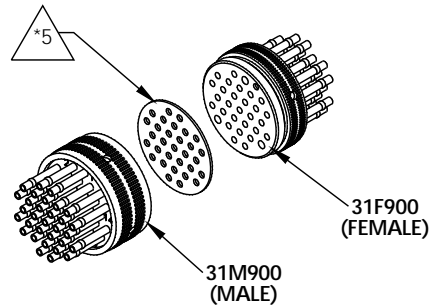
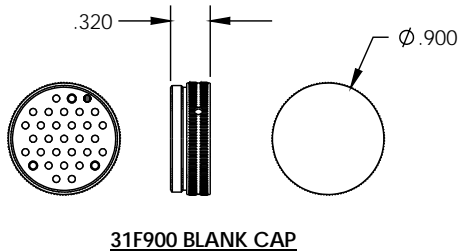

-1 31 PORT CONNECTOR (31M900/31F900), .063 & .040 TUBE

UNLESS OTHERWISE SPECIFIED:		DATE		NAME		Scanivalve LIBERTY LAKE, WA			
DIMENSIONS ARE IN INCHES		DRAWN	6-2-14	SH					
TOLERANCES:		CHECKED	6-2-14	BCB		TITLE: 31 PORT CONN., .063 & .040 (31M900/31F900)			
TWO PLACE DECIMAL ± .015		ENGINEER	6-2-14	BCB					
THREE PLACE DECIMAL ± .005		MODEL REV: -							
SHEETMETAL PARTS ± .010									
BEND RADIUS .06 MAX									
ANGULARITY ± 1.5°									
MATERIAL									
FINISH						SIZE		DWG. NO.	REV
TOOLBOX						B		81335	-
DO NOT SCALE DRAWING		CAD: SOLIDWORKS 2014		SCALE: N/A		ERO#:		SHEET 1 OF 1	