

**NOTES:**

1. APPLY A SMALL AMOUNT OF SEALANT (SLNT2) WITH A PAINT BRUSH TO THE STAINLESS TUBN-XXX. (FIG. 1).
2. PUSH TUBING OVER THE BULGED TUBE (TUBN-XXX) USING TPOTL-XXX AS SHOWN (FIG-2).
3. SLIDE NYCLMP-XXX DOWN PLASTIC TUBING (FIG. 2) AND SCREW OR PUSH NYCLMP-XXX DOWN THE TUBN-XXX (FIG. 4). STOP DRIVING AS THE NYCLMP-XXX JUST PASSES CENTER OF THE TUBN-XXX BULGE (FIG-4). REFER TO CATALOG FOR NCSBTL2-XXX OR NCSBTL3-XXX FOR CLAMPS AND TPOTL TUBING.

REVISIONS			
REV	DESCRIPTION	DATE	APPROVED
-	INITIAL RELEASE	7/26/22	NB

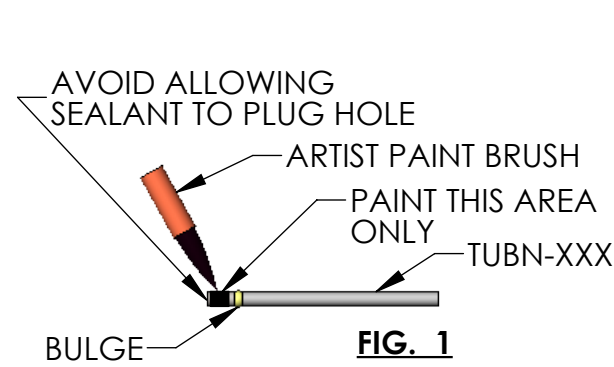

**NOTE: RECOMMENDED CURE TIME FOR SEALANT IS 48 HOURS.**

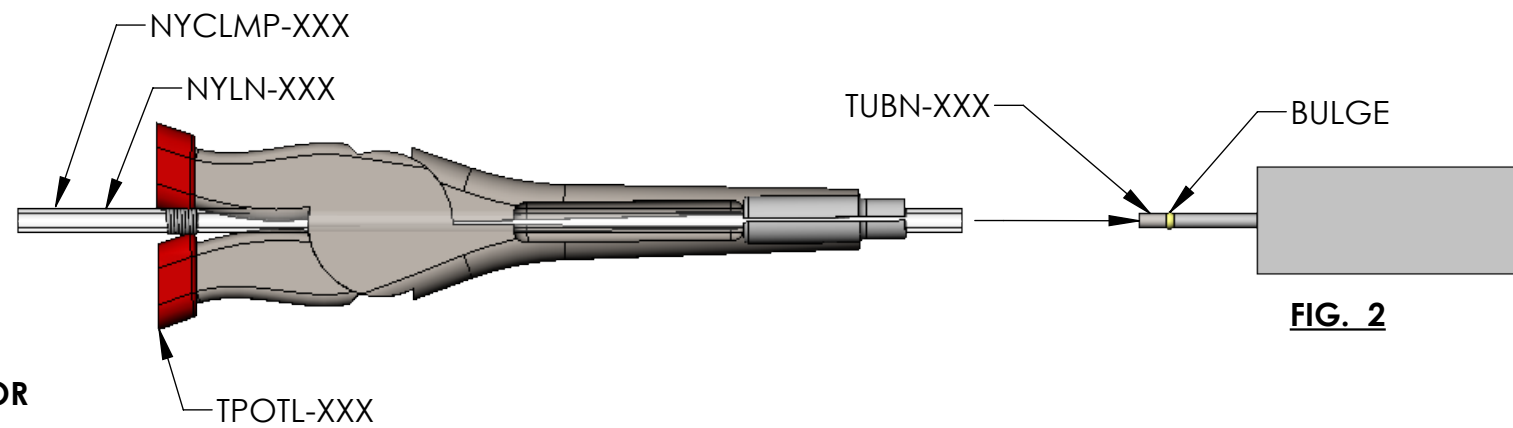

**FIG. 2**

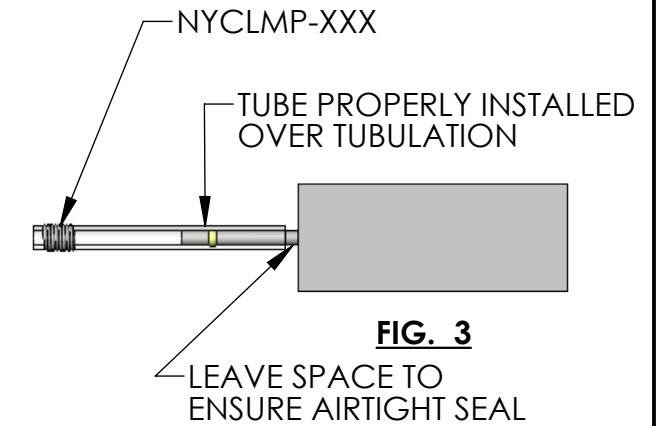

**FIG. 3**



**FIG. 4**

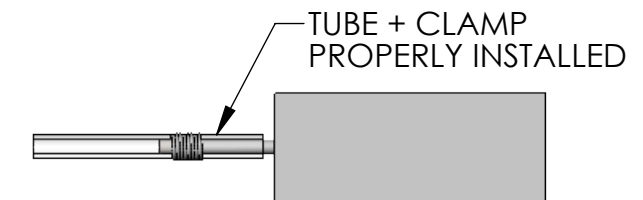

**FIG. 5**

**NOTES:**

1. SEE ABOVE FOR PLASTIC TUBING INSTALLATION TO TUBULATION (TUBN-XXX).
2. FOR ASSEMBLY, SLIDE 57038-X UNTIL MAKING CONTACT WITH THE BOTTOM OF THE COMPRESSION FITTING. TIGHTEN THE NUT AND FERRULE ONCE THE 57038-X ADAPTER IS FULLY SEATED.

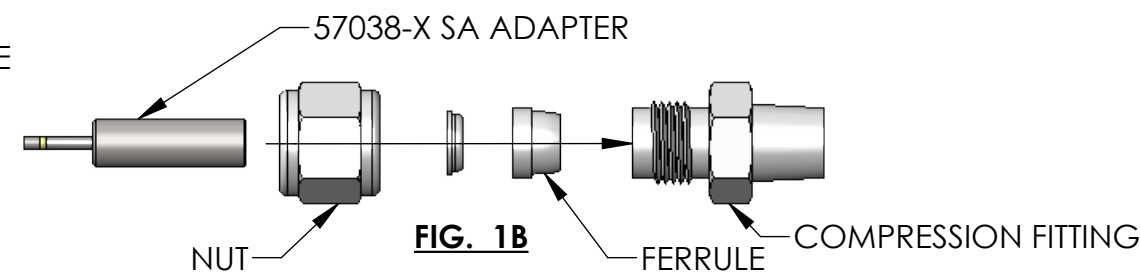

**FIG. 1B**

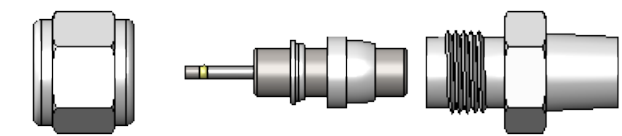

**FIG. 2B**

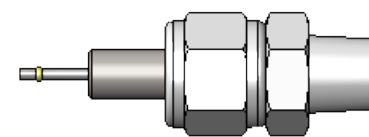

**FIG. 3B**

UNLESS OTHERWISE SPECIFIED:  
 DIMENSIONS ARE IN INCHES  
 TOLERANCES:  
 TWO PLACE DECIMAL ± .015  
 THREE PLACE DECIMAL ± .005  
 SHEETMETAL PARTS ± .010  
 BEND RADIUS .06 MAX  
 ANGULARITY ± 1.5°

DRAWN		DATE	NAME	<p><b>Scanivalve</b> LIBERTY LAKE, WA</p> <p>TITLE: INSTRUCTIONS FOR NYLON TUBING, CLAMPS, &amp; COMPRESSION FITTING INSTALL</p>	
CHECKED		1/27/99	NSH		
ENGINEER					
CUSTOMER APPROVAL:		DATE:	SIZE	DWG. NO.	REV
			B	80198	-
DO NOT SCALE DRAWING		CAD: SOLIDWORKS 2017	SCALE: N/A ERO#:		SHEET 1 OF 1

\*SEE SCANCO PNEUMATIC ACCESSORIES CATALOG FOR INTERPRETATION OF SCANCO CATALOG NUMBERS USED ABOVE.